

EXTERNAL WALL SECTION - END WALLS - DETAIL (4)

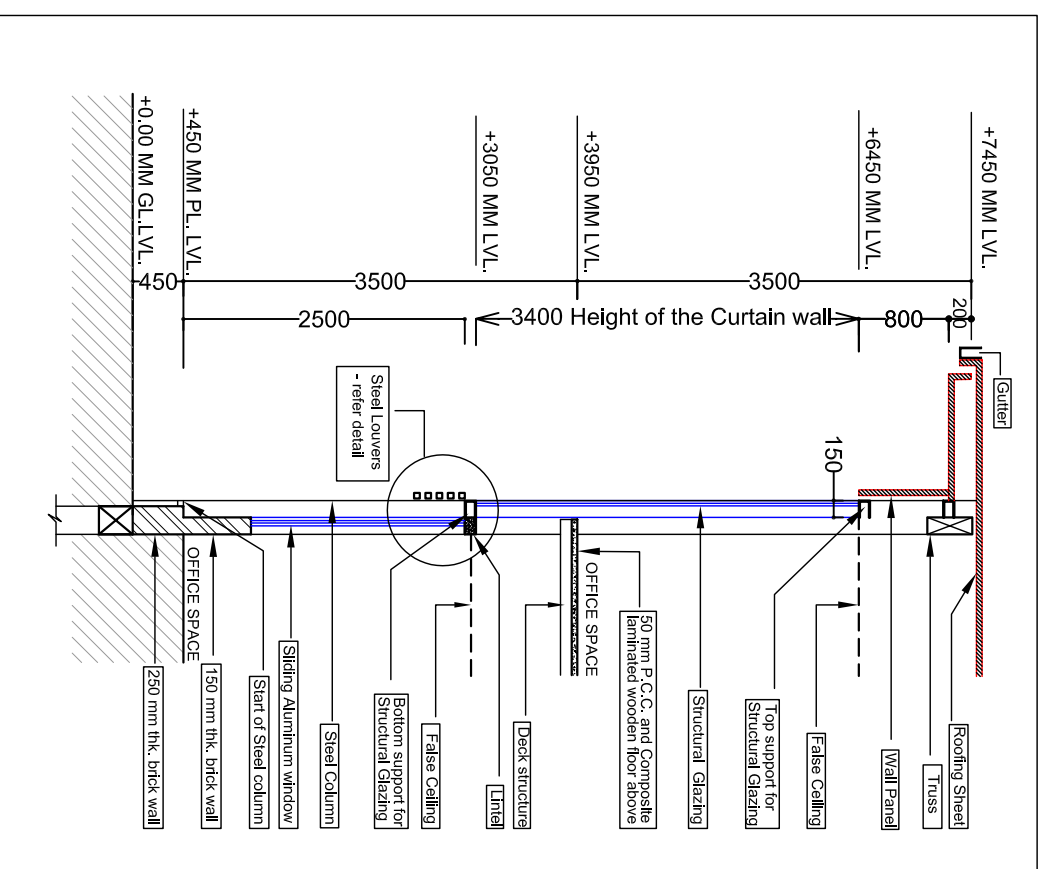

EXTERNAL WALL SECTION - END WALLS - DETAIL (5)

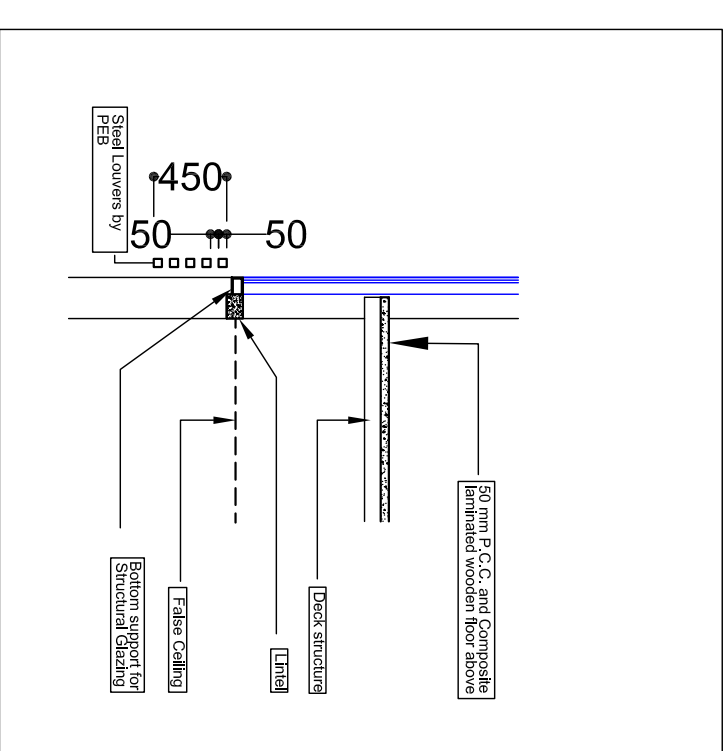

DETAIL OF STEEL LOUVERS

NOTE : Distance between Top and Bottom Support for Curtains wall will be 3400 mm .  
: Width of Steel Jamb / Support for the Curtain wall on all four sides will be 150 mm.



PROPOSED OFFICE BUILDING FOR  
NUMALIGARH REFINERY LIMITED  
AT G.S. ROAD, GUWAHATI

DRAWING FOR TENDER  
END WALL DETAILS

PROJECT

DRAWING

PROJECT CONSULTANT

PROJECT ARCHITECT

SCALE

DATE

REVISION

**CADMETRIC Consulting**  
RAJGARH ROAD, CHANDMARAI  
GUWAHATI - 781003, ASSAM  
PHONE & FAX: -0361-2461632.  
PROJECT MANAGERS CIVIL/STRUCTURAL ENGINEERS

RITTICK HAZARIKA ARCHITECT  
A1 MANDOVITILLOTTAMA ENCLAVE,  
AMBARI, G.N.B. ROAD GUWAHATI.

AS NOTED

05. 12. 09

DRAWN BY  
JOGITA KALITA

DRG NO  
NRL/TRNS OFF/CV/06

ISSUED FOR APPROVAL - 05 - 12 - 09